



DLR Group inc.
a Nebraska corporation

6457 Frances Street, Suite 200
Omaha, NE 68106

June 6, 2022

AIA Nebraska
335 N. 8th Street, Suite A
Lincoln, NE 68508

Re: AIA Nebraska Young Architect Award

Dear AIA Nebraska Jury Members:

It is my pleasure to offer my sincere recommendation of Matthew Gulsvig for the distinguished AIA Nebraska Young Architect Award.

Matthew is vital to DLR Group's mixed-use sector and has made an immense positive on several projects in Nebraska of both notoriety and scale. He is able to easily identify challenges, offer a multitude of unique ways to solve them, and produces nothing short of high-quality results in everything he is involved in. Matthew is well-known for his contributions to our firm, but even more so for the dry sense of humor and fun demeanor he delights everyone with no matter what the situation. He is the one you can count on to do the job right and to brighten your day in the process.

Beyond his role in our firm, Matthew has made the lives of those he works with easier by inventing the AlumiDrafter, which is a drafting and measuring tool for architects, engineers, and contractors. He is constantly thinking about ways to help others do better and is always excited to learn and evolve. He is also heavily involved in mentorship programs in the community and at DLR Group. I have personally witnessed how he takes the time to explain and show young designers not just *how* things are done, but *why*, with grace and patience.

Matthew is fully committed to the betterment of the architecture profession, is a champion of quality design, and cares deeply about his peers. He absolutely deserves this recognition.

Sincerely,

A handwritten signature in black ink, appearing to read "Vanessa Schutte".

Vanessa Schutte, AIA, ALEP
Principal | Architect

ELEVATE *the*
HUMAN EXPERIENCE
THROUGH DESIGN

Matthew Gulsvig, AIA, NCARB, LEED AP

Principal | Architect



Matthew Gulsvig was born at a very young age... Yes, that is a joke. If you know him, that should not come as a surprise. Matthew strives to share and create smiles and joy for all. He has had many nicknames, the most consistent of which being, "smiley." He was dubbed this name while working his first real job bagging groceries at Piggly Wiggly when he was 14 years old. Matthew learned that a simple smile or joke could have a positive impact on one's life. It not only makes others feel good, but it also makes Matthew feel good.

Growing up in a household filled with love and encouragement, Matthew's small family (not only in population, but also in stature), was predominantly of Norwegian and agricultural decent. His upbringing taught him the significance of a strong work ethic and ingenuity. This foundation, coupled with his extracurricular activities of Kyuki-Do, guitar, baseball, and powerlifting helped him develop a personal code of ethics that is based in honesty, integrity, and

perseverance. This code serves as his personal framework for achieving his goals.

Matthew's path through life has by no means been a traditional one. His main focus is to explore new opportunities. He was born in Jamestown, N.D. and lived in Syracuse, N.Y., but primarily grew up in Racine, Wis. Ever since that first job at 14, he maintained a job while attending school. He made the decision to move away from home, without knowing anyone, to pursue his childhood dream of becoming an Architect at the University of Minnesota-Twin Cities. At that time, students were required to apply to the College of Architecture after completing general education requirements. Unfortunately, Matthew was not accepted following his first attempt. This hurdle did not stop him from pursuing his dream. He smiled, focused on his goal, and tapped into his perseverance. He reapplied and was accepted.

Following graduation, he lived and worked in Minneapolis for a little while to gain professional experience, as well as to prepare and save money for graduate school. He looked at schools across the nation, but all signs pointed to Nebraska. He applied to the College of Architecture at the University of Nebraska-Lincoln and was denied once again, but once again, he did not give up on his dream. He smiled, focused on his goal, and decided to move to Nebraska, again without knowing anyone. Matthew's first year was spent working at a local architecture firm while simultaneously pursuing a Master of Engineering degree. He reapplied to the College of Architecture the following year and was accepted. Matthew graduated with a dual Masters Degree in Architecture and Engineering.

In 2011, positions at architecture firms were extremely limited. Rather than taking the common approach of simply applying online or emailing resumes and portfolios, Matthew created a plan. He identified all of the architecture firms between Lincoln and Omaha, printed resumes, portfolios, personalized cover letters and maps, donned a suit, and climbed into his 2001 gold F-150 to continue his pursuit of his dream. Matthew drove to each of the identified firms, asked to speak to the person in charge, and shared his documents. He was grateful to have his efforts land him a position. Today, he enjoys his role as a Principal at DLR Group. He leads with his heart as he guides his clients, team members and projects through a process to achieve goals. His passion lies in improving his community by doing great design with great people.

Matthew's passion for design, problem-solving, and thirst for growth encourages him to raise his hand and take on difficult issues. His approach to design and problem-solving is based on observation, listening, and inquiry. He identifies the parameters and outlines a path. This approach is not only steadfast in his design work, but life in general.

Outside of work, you can find him spending time practicing yoga, golfing, jogging, hiking, reading, music, traveling and spending time with people who are filled with joy.

Statement of Contributions

Matthew is dedicated to serving his community and industry through his personal manta of “Creative Problem Solving to Better the Lives of Others.”

Licensing, Registration, & Affiliations

Registered Architect, Nebraska No. A-4533

2015-Present

As a Registered Architect in the state of Nebraska, Matthew stays informed of state laws and requirements of the profession through the State of Nebraska Board of Engineers and Architects.

National Council of Architectural Registration Boards (NCARB)

Certified National Member; 2015-Present

As a member of NCARB, Matthew stays up-to-date on the national policies and trends affecting the profession of architecture, including changes in educational and training requirements.

American Institute of Architects

Nebraska Government Affairs Committee

Nebraska, 2013-Present

As a member of this small group, Matthew helps review legislature and other policies that affect the profession of architecture in Nebraska. Collectively, our group takes positions on topics as representatives of the architects in Nebraska.

American Institute of Architects (AIA)

National, Nebraska and Omaha, 2015-Present

As an AIA member, Matthew stays informed of national and local issues that affect the architecture profession.

International Facility Management Association (IFMA)

Omaha, Neb., 2016-2017

Throughout his involvement with the IFMA, Matthew participated in networking events and tours.

LEED Accredited Professional

2009-Present

As a LEED Accredited Professional, Matthew stays informed on sustainability and its impacts on the built environment.

Community Involvement & Volunteering

Greater Omaha Heart & Stroke Walk; Omaha, Neb.

May 2022

Matthew donated and participated in this fundraiser event to help raise awareness as well as to help celebrate survivors and volunteers.

Leadership Sarpy; Sarpy County, Neb.

Class of 2019-2020

Matthew applied and was accepted into the Leadership Sarpy program, where he actively participated in opportunities that helped grow his leadership experience and benefit the Greater Omaha community. Through the program, Matthew not only strengthened his leadership skills, but also developed great relationships that will directly improve the community. His legacy team developed a resource guide that is being used by first responders and the community.

SAME Student Mentoring Program at Westside High School; Omaha, Neb.

September 2015-Present

Matthew serves as a volunteer mentor for high school students who are interested in architecture and engineering.

He actively meets with the student teams to help guide their projects towards a final presentation. His primary responsibilities include the following: providing direction and guidance for the students' projects, serving as a resource for questions, sharing connections to other professionals within the industry, and reviewing their work. This volunteer position requires the utilization of the expertise of both a teacher and a leader to allow the students the opportunity to cultivate and creatively learn. Additionally, they become more aware of real-world challenges they may face in the duration of a successful project.

Pranam Yoga Shala; Omaha, Neb.

May 2017-Present

Matthew attends classes and donates regularly. While his initial purpose for joining the yoga studio was focused on improving wellness, he has fully embraced the lifestyle and his participation has evolved to include volunteering for the Seva Program. Through the Seva Program, prior to the pandemic, Matthew helped support the community by being involved in a variety of public service projects, including helping set up and furnish homes for refugees.

Wear Yellow Ride; Omaha, Neb.

September 2017, September 2018

Matthew participated in a bike ride to raise money awareness, and support cancer survivors in Nebraska.

American Lung Association; Omaha, Neb.

September 2017, September 2018

Matthew participated in a running event and fundraiser, which was coupled with an opportunity to assist the American Lung Association in the fight against lung disease. It required Matthew to take the initiative to solicit and maximize donations for an important charity.

Abide Omaha; Omaha, Neb.

May 2016

Matthew actively participated in a DLR Group-sponsored volunteer day to improve the condition of an existing house in an area of the Omaha community that does not frequently receive support. The efforts included minor repairs, and the painting and landscaping of two neighboring homes.

Habitat for Humanity; Omaha, Neb.

May 2014

Matthew lent his expertise and physical labor in support of the betterment of the community with improved housing for families in need.

Susan G. Komen Foundation Race for the Cure

Omaha, Neb., October 2018

Minneapolis, Minn., May 2005-2010

In honor of a family member's success against breast cancer and to help others in their fight, Matthew continues to participate in the Susan G. Komen Foundation running event and fundraiser, which supports research and awareness.

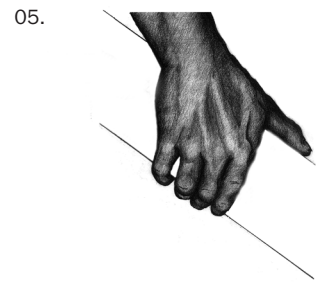
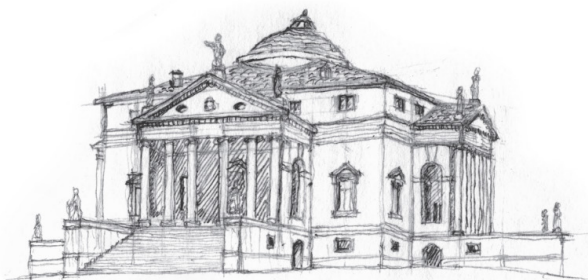
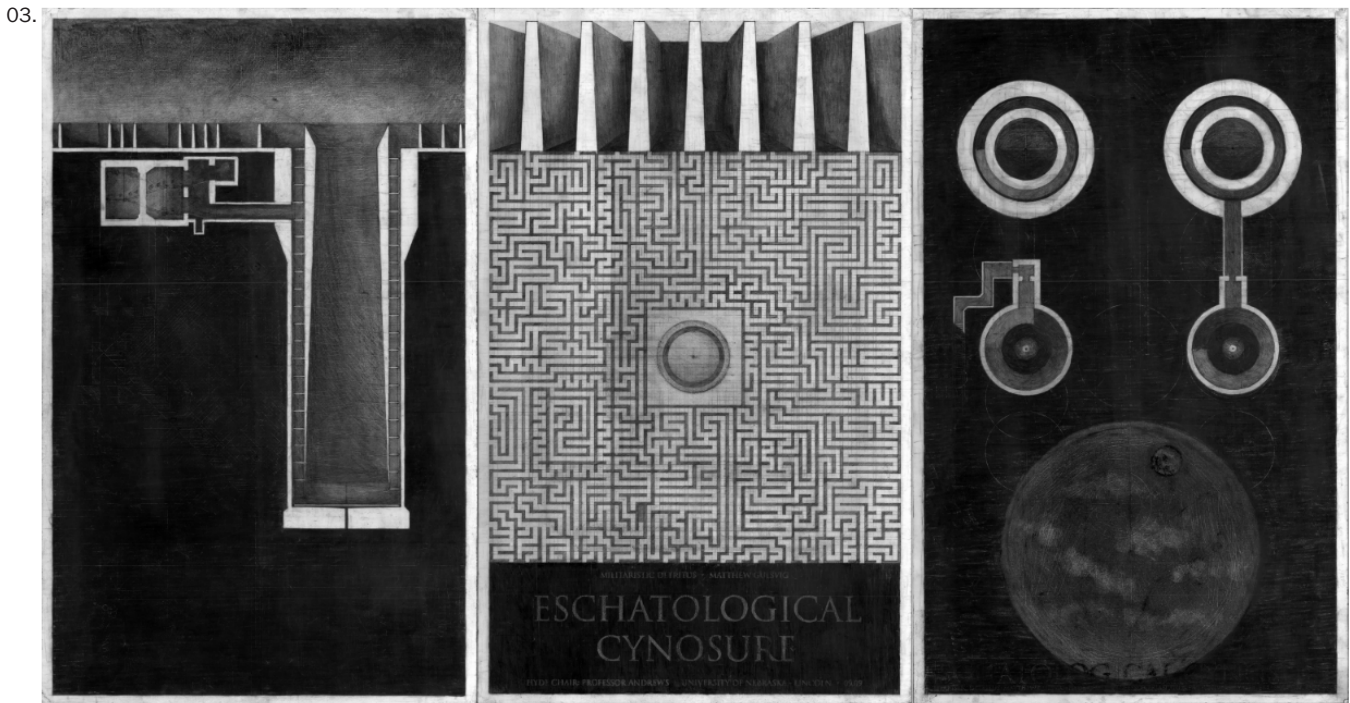
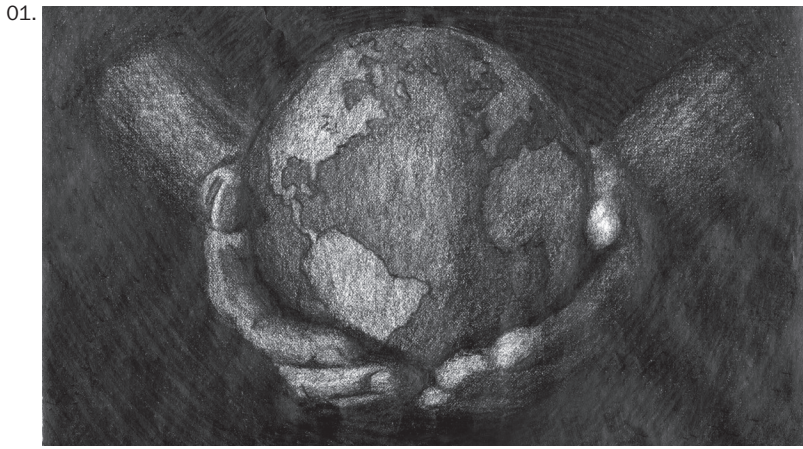

Hand Drawings and Paintings

- 01. "The World is in Your Hands," 8x6," graphite on vellum
- 02. "Christ," 20x16," acrylic on canvas
- 03. "Exchatological Cynosure," three 20x32" graphite on paper using a palimpsest technique
- 04. "Sketching Italy," three 3x3," graphite on paper
- 05. "Hand on Handrail," 8x8," graphite on vellum

The Greater Omaha Chamber of Commerce

| Omaha, Neb.



“Catalyst for Community Growth” Project Manager Completed Spring 2018

As the project manager for this relocation and renovation project, Matthew utilized his strong organizational skills to help guide and coordinate multiple project stakeholders and team members to shaping the design of this unique project. During this project, Matthew volunteered with the newly created REACH program to help small-emerging construction companies develop skillsets related to the industry. The activities that take place within this space will have unquantifiable impacts on the Greater Omaha Metropolitan Area and the State. Matthew feels honored to have been an integral team member of this catalyst project.

RTG Medical Office Building

Fremont, Neb.



*“Helping to Care for the Nation”
Architect of Record, Project Manager, and Coordinating Professional
Anticipated Completion Summer 2022*

*“RTG Medical is a veteran-owned healthcare staffing agency that partners with and connects traveling healthcare professionals to job opportunities all across the country.”
Design does not simply impact those who occupy it. Matthew is grateful for the opportunity to be the lead architect that created a space for people who help take care of people in need all over the nation.*

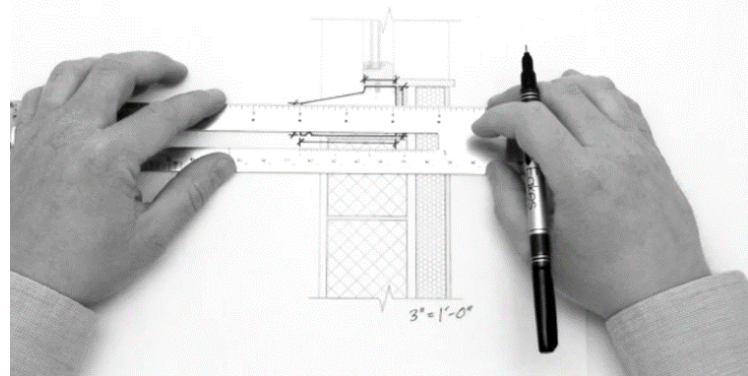
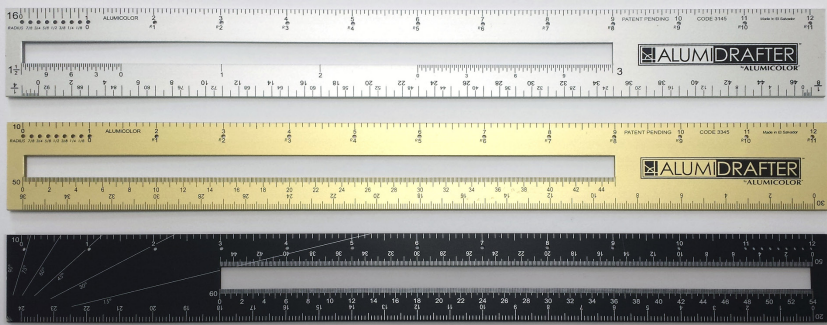

A drafting and measuring tool for architects, engineers, and contractors

| Invented by Matthew Gulsvig, 2016

Project Description

The AlumiDrafter is a product of frustration. Traditional three-sided architectural and engineering scales do not lay flat in a folder, folio or briefcase. Previously, the only alternative was to buy a two-sided scale, but they do not have all of the calibrations that were on a three-sided scale. In an attempt to remedy this frustration, I began to design multiple iterations to address the problem. I determined that additional “perimeter” area was needed in order to locate the calibrations that were missing from the two-sided scale. This was achieved through the opening in the middle of the scale.

After resolving that design problem I continued to ask questions about the tool. “How can I add functionality and incorporate other features?” I looked through my drafting tool box and realized that I had compasses that were essentially the same, a ridiculous number of drafting triangles, protractors and a ruler I used as a cutting edge. Through additional design iterations, I was able to incorporate these features into the design of the AlumiDrafter.

Upon settling on the design, I didn’t want to stop. The next challenge was to make this a commercially viable product. I knew I did not want to manufacture and sell rulers because this would take time away from my passions of design and problem solving. I contacted AlumiColor because their products match the quality that I had envisioned for the AlumiDrafter. After proposing my idea to them and negotiating terms, we agreed to work together to bring this product to the market. During my discussions with AlumiColor, I knew I would incur costs associated with developing and launching the product. Financing was simply another part of the process that required creative problem solving. After building financial models and brainstorming options, the use of the Kickstarter website quickly became the best method to address this part of the process.

Over a time period of approximately 18 months, an idea that was born out of frustration became a real product that I am happy to say can be purchased directly from AlumiColor, online or in retail stores.

It Takes A Community

The AlumiDrafter came to life through the support of multiple communities that are dependent on one another yet may not recognize their interrelations.

The first is a Kickstarter Community made up of family, friends, colleagues and strangers. These individuals not only helped create awareness through social media and emails, but also helped by making contributions to the Kickstarter campaign which ultimately allowed this concept to become a reality.

The second community is the staff at AlumiColor. This group of people was and still is, integral to the success of this undertaking. The AlumiColor Community played a significant role in helping to create prototypes, develop the name and logo, and determine price point and projected sales. They also manufacture, package, ship, market, sell and process orders.

The third community includes all of the third-party vendors, distributors and retailers who are involved in the process of getting the AlumiDrafter to the consumer. These individuals deliver shipments, stock shelves and sell the product at the point of sale.

The final community consists of Architects, Engineers, Contractors, Academics, Students and Hobbyists who purchase and use the AlumiDrafter. These consumers allow the product to be a continued success. Ultimately the AlumiDrafter was created for this group of individuals and their acceptance of the product helps support the other communities. Each AlumiDrafter touches many hands during its life, from material extraction through the use by the consumer.

2016 AIA National Emerging Professional Exhibit

Sold at Major Retailers, including Amazon, Walmart, and Hobby Lobby

Promotional Agreements with the AIA Store and Frank Lloyd Wright Store

Nebraska Realty

| Lincoln, Neb.

*Architect of Record
Project Manager and Coordinating
Professional
Anticipated Completion Fall 2022*

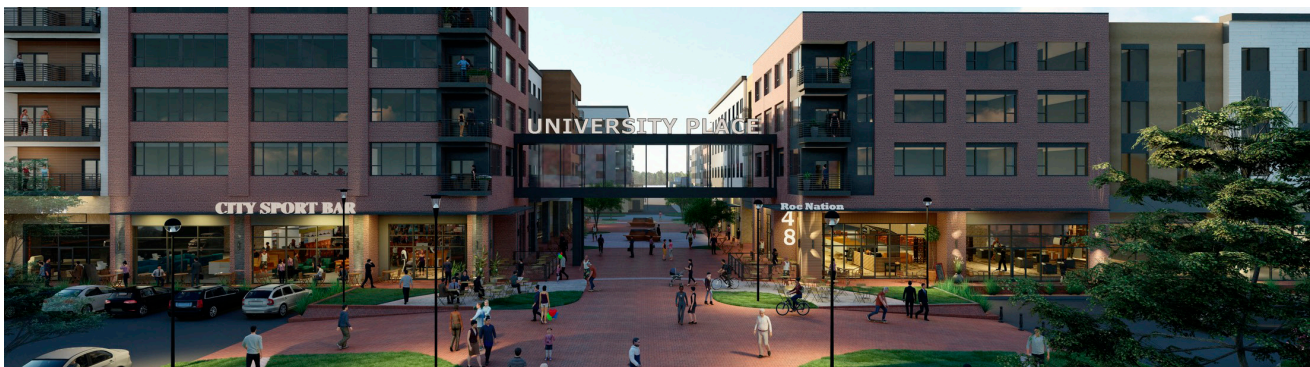

Leighton District

| Lincoln, Neb.

*Architect of Record
Project Manager and Coordinating
Professional
Completed 2021*

McCarthy Building Companies Regional Office Building

Omaha, Neb.



*Architect of Record
Project Manager and Coordinating Professional
Completed 2020*

Matthew appreciates the long-term relationships that developed out of this project. The design of this project was intended to showcase the work McCarthy does, coupled with representing their established presence within the community.

First National Bank

| La Vista City Centre; La Vista, Neb.

*Project Manager and Coordinating Professional
Completed 2019*

The First National Bank in La Vista City Centre was one of the first projects completed in the new development.



La Vista City Center Parking Garage No. 1

| La Vista, Neb.

*Architect of Record
Project Manager and
Coordinating Professional
Completed 2021*



La Vista City Centre Parking Garage No. 2

| La Vista, Neb.

*Architect of Record
Project Manager and Coordinating Professional
Anticipated Completion Summer 2023*

Matthew has worked with multiple stakeholders over the last five years to help shape La Vista City Centre. These stakeholders include city officials, public and private owners, several contractors, and multiple design firms. Collaboration, communication, and coordination is paramount.



Notable Nebraska Projects

Matthew has experience working in jurisdictions across the United States. The following is a brief list of some of the notable projects in Nebraska. Matthew served in a primary role, was the lead designer, or the Architect of Record.

Lincoln, Neb.

University Place Mixed-Use Development / Leighton District
Nebraska Realty New Office Building
Habitat for Humanity ReStore
Salvation Army Renovation & Addition

La Vista, Neb.

La Vista City Centre Parking Structure No. 1
La Vista City Centre Parking Structure No. 2
First National Bank La Vista Branch Bank
PayPal Omaha Building 1

Fremont, Neb.

RTG Medical Corporate Headquarters

Grand Island, Neb.

Lutz Company New Office Building at Prairie View Plaza
Liberty Campus, Nebraska Veterans Home Redevelopment

Hastings, Neb.

Lutz Company Office

Omaha, Neb.

General Fire and Safety Headquarters
McCarthy Building Companies Regional Office Building
Union Pacific Railroad Headquarters Cafe and Entry Plaza
Greater Omaha Chamber of Commerce's Office
Green Plains Regency Office
Green Plains Aksarben Office
Aksarben Village Zone 5 Master Planning
Aksarben Village Pacific Life Mixed-Use Building
Aksarben Village Zone 5 Parking Garage and Skywalk
Lumberyard Mixed-Use District
Pavilion at Turner Park
Creighton Prep David P. Circo Memorial Plaza
ZNETH I (Zero Net Energy House One)
ZNETH II (Zero Net Energy House Two)

McCook, Neb.

Armed Forces Readiness Center

Professional Experience

Matthew is grateful for the knowledge and mentorship he gained from his current and prior professional experiences.

DLR Group

Principal, Architect | Omaha, Neb. | February 2016-Present

Holland Basham Architects

Associate, Design Architect and Project Architect | Omaha, Neb.
| October 2012-January 2016

Architecture Etcetera

Project Coordinator | Lincoln, Neb. | August 2011-September 2012

Sinclair Hills Architects

Architectural Intern | Lincoln, Neb. | January 2011-August 2011
(Full-Time), September 2008-January 2010 (Part-Time)

University of Nebraska-Lincoln

Architectural Research Assistant, Part and Full-Time | Lincoln, Neb. | February 2007-August 2008

CMA Architecture

Project Coordinator, Full-Time | Minneapolis, Minn. | February 2007-August 2008

Tanek Architecture

Architectural Intern, Part and Full-Time | Minneapolis, Minn. | October 2005-February 2007

Education

University of Nebraska-Lincoln; Lincoln, Neb.

Master of Architecture
Master of Engineering in Construction
Minor in Business

University of Minnesota-Twin Cities; St. Paul, Minne.

Bachelor of Science in Architecture
Minor in Construction Management



June 1, 2022

AIA Nebraska
335 N 8th St, Ste A
Lincoln, NE 685008 – 1300

RE: AIA Nebraska – Young Architect Award – Consideration of Matthew Gulsvig, AIA LEED AP

Dear Selection Committee Members,

It is my distinct pleasure on behalf of the City of La Vista to hereby recommend consideration of the AIA Nebraska Young Architect Award to Matthew Gulsvig, AIA LEEP AP, Principal, DLR Group. The City has been working with Matthew and his team for several years on the design and construction of the City’s first ever parking garages, Parking Structure No. 1 and Parking Structure No. 2, located in La Vista Off Street Parking District No. 2 or generally near the intersection of 84th Street and City Centre Drive.

Matthew has demonstrated his worthiness of this award through his leadership, understanding of and advocacy for his clients, and his willingness to work across the table in partnership to provide the City, the redevelopment team, and the general public with a high quality-high aesthetic work product that will forever change the look and feel of 84th Street, which is generally recognized as one of La Vista’s main transportation and business corridors.

Throughout design, Matthew has led a team of industry professionals through the difficult process of designing new structures within the 84th Street Redevelopment Area that are functional, pleasing, and ready for a long service life to the public. Matthew’s attention to detail and finger on the pulse of Industry has provided the City with a highly functional and highly durable Garage Structure No. 1 and currently is a partner in the construction of Parking Structure No. 2, scheduled to the open in Summer 2023.

As a consummate professional and a partner to the City, Matthew has worked tirelessly to improve upon the design and quality of these structures, addressing the City’s needs while understanding the need for fiscal constraint in devising cost-effective, transparent solutions. He worked with stakeholder groups and elected officials to understand the needs and wants of

City Hall 8116 Park View Blvd. La Vista, NE 68128-2198 402.331.4343 P 402.331.4375 F	Community Development 8116 Park View Blvd. 402.593.6400 P 402.593.6445 F	Library 9110 Giles Rd. 402.537.3900 P 402.537.3902 F	Police 7701 S. 96th St. 402.331.1582 P 402.331.7210 F	Public Works 9900 Portal Rd. 402.331.8927 P 402.331.1051 F	Recreation 8116 Park View Blvd. 402.331.3455 P 402.331.0299 F
---	--	--	---	--	---

CityofLaVista.org



the community, and to understand the other redevelopment projects in the vicinity to coordinate efforts throughout the 84th Street Redevelopment Area, understanding the interconnectedness of all the project area as a whole. Matthew takes the time to be multiple steps ahead of the contractor to try and work through the bumps of a project long before they become critical issues, and his open door, call anytime philosophy is not lost on me or the City. I am not afraid to admit I have utilized his generous offer many times to put my mind at ease and to help me through processes I am not overly familiar with.

In closing, it has been an honor to work **WITH** Matthew and his team on these projects, I would highly recommend Matthew for other projects such as these, even in his relatively short professional tenure. I would not hesitate to put him on any City team now or in the future. Thank you again for this opportunity, and I wish you well on your evaluations. Should you need anything additional from me, please contact me via email pdowse@cityoflavista.org, or via telephone, 402-981-5393.

Sincerely,

Patrick M. Dowse, PE
City Engineer

City Hall
8116 Park View Blvd.
La Vista, NE 68128-2198
402.331.4343 P
402.331.4375 F

Community Development
8116 Park View Blvd.
402.593.6400 P
402.593.6445 F

Library
9110 Giles Rd.
402.537.3900 P
402.537.3902 F

Police
7701 S. 96th St.
402.331.1582 P
402.331.7210 F

Public Works
9900 Portal Rd.
402.331.8927 P
402.331.1051 F

Recreation
8116 Park View Blvd.
402.331.3455 P
402.331.0299 F

CityofLaVista.org



DLR Group inc.
a Nebraska corporation
6457 Frances Street, Suite 200
Omaha, NE 68106

June 05, 2022

LOR: On behalf of Matthew Gulsvig

Dear AIA NE Young Architect Committee:

As the Global Workplace Leader at DLR Group I have the opportunity to work with all our teams across the country. We have a group of over 125 dedicated members and employ a One Workplace strategy where the best people work with the right client regardless of location.

Matthew and I first collaborated on a proposal for LinkedIn nearly four years ago and since that time many opportunities have arisen. Matthew is part of the leadership team in our Central region which consists of Omaha, Lincoln, and Des Moines. He is tasked with working to help establish a business plan, win new work, oversee design excellence, and mentor the next generation of architects. To say he has been successful would be an understatement – in a short time he has moved up through leadership and was made principal almost two years ago. His team loves working with him because he is a great mentor and remembers to have fun - the two most important aspects of a successful design firm, in my opinion.

Over the last three years we have seen the Central Workplace team grow as both projects and clients of desire continue to create momentum. This year we will experience a substantial increase in revenue and staff due to the groundwork Matthew and team have established.

What makes Matthew truly unique? His mind. Matthew is always thinking about creative problem solving, whether at work, at home, or anywhere else you might find him. He has several patents in the works for products he has designed to help solve everyday problems. That way of thinking overflows into his work which results in clients that are dedicated to working with him and employees that request to be part of his team.

Matthew is exactly the kind of young architect we should be celebrating, and I cannot wait to see how far he goes during his career.

Sincerely,
DLR Group

A handwritten signature in black ink, appearing to read "J. Reding".

Jeremy M Reding, AIA
Global Workplace Leader | Senior Principal

cc: