



**CARLSON
WEST
POVONDRA**
ARCHITECTS

5060 Dodge Street
Omaha, Nebraska 68132
402.551.1500

cwparchitects.com

July 1, 2023

2023 AIA Nebraska Honor Awards Jury
AIAS Student Award
AIA Nebraska
335 N. 8th Street, Suite A
Lincoln, NE 68508

Re: 2023 AIA Nebraska Associates Award Nomination

Dear 2023 AIA Nebraska Associates Award Jury Chairperson and Jury Members,

It is my pleasure as a member of the AIA Omaha Board of Directors, AIA Nebraska Board of Directors, and past Chairperson of the AIA Nebraska Emerging Professionals Committee to be the nominating sponsor of Emily Roesler, Assoc. AIA for the 2023 AIA Nebraska Associates Award.

I have known Emily since our time in the architecture program at the University of Nebraska-Lincoln. After graduating we have frequently collaborated through AIA Nebraska and AIA Central States. Emily was integral to the formation of the AIA Nebraska Emerging Professionals Committee, where she served as the first Chairperson and laid a strong foundation for others to follow. Under her leadership, the committee grew in numbers and became one of the most active components in the state. Emily is currently an active member of the committee and, although her term as chair expired, she is a natural leader and someone that can always be called upon to engage in new projects.

Emily's role on the AIA Nebraska Emerging Professionals Committee, also made her a natural fit for the AIA Central States Emerging Professionals Committee, which she also Chaired. I had the privilege of being on this committee as well to witness firsthand how significant of an impact she made as a representative of our state. In fact, as a member of the National Associates Committee, I find myself often running into former AIA Central States members who are always quick to remark fondly on their time getting to know Emily and how much they appreciate her work. Between organizing student project competitions or the AIA Central States Friendly Firm Award, Emily's crucial role in Central States initiatives left an impact that extended beyond the committee and into conversations at a national level.

As a natural leader, it should come as no surprise that Emily is serving as the AIA Nebraska Lincoln Section President. Through her involvement in AIA Lincoln and her community, Emily has been able to build strong relationships leading to some exciting community projects. One such project is the Big B.A.D. Birdhouse Project, in which AIA Lincoln partnered with Spring Creek Prairie Audubon Center to integrate concepts of art and architecture with Spring Creek's conservation efforts to protect native wildlife. Emily's ability to facilitate invaluable partnerships creates strong mentorship and learning opportunities, which ultimately act as instruments of advocacy for our profession.

It is without hesitancy that I nominate Emily Roesler for the 2023 AIA Nebraska Associates Award. Emily's positive impact on our profession is immeasurable and her efforts at this stage of her career are worthy of recognition.

Respectfully submitted,

Kevin Baitey, Assoc. AIA
Carlson West Povondra Architects

2022 AIA Nebraska Associates Award Recipient

Emily Roesler, Associate AIA

Associate | Designer



Emily Roesler is a born-and-raised Lincolnite who pursued architecture because of the social impact it has on communities. Growing up, Emily recognized its ability to not only tell stories and embed itself in memories, but also to realize dreams and propel us toward the future. She believes architecture has the power to create positive change and is driven to use it as a catalyst in her contributions to the community. Emily began her formal education at the University of Nebraska-Lincoln as an architectural engineering major before shifting her focus solely to architecture. She values that experience as an important steppingstone in her design journey. Before earning her Master of Architecture degree in 2017, Emily served as a small project manager and a teaching assistant for the university. Upon graduation, Emily joined DLR Group, where she achieved associate distinction within three years of employment. Educational design is her passion, and she has participated in 16

educational design projects. Emily recognizes that every learning environment she helps create has an important role in each student's education, which motivates her commitment to producing the highest quality design possible. It is a priority to Emily to support the American Institute of Architects at local, state, and regional levels. She currently serves as AIA Lincoln President, the first Associate AIA to ever hold that position in Lincoln. She also serves as an AIA Nebraska Emerging Professionals Committee member. Emily's dedication to AIA stems from her ambition to create lasting change, which she knows is apart of the fabric of the organization. When she is not serving her community or developing her architectural expertise, Emily loves to spend time with Luke, her husband and best friend of 15 years. They enjoy participating in a local sand volleyball league, Marcus Theater \$5 movie Tuesdays, and as many wine tastings as they can.

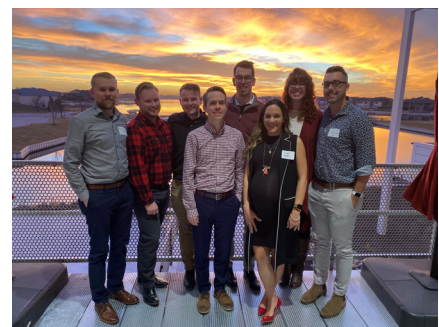

Statement of Contributions

Emily is an original Lincolnite, born and raised. She is involved with the AIA at local, state and regional levels. Proving her passion for the architectural community.

American Institute of Architects

AIA Lincoln

Associate Director (2018, 2019)
President Elect (2021, 2022)
President (2023-Present)

Initiatives: Big B.A.D. Birdhouse Project (2021-Present)

AIA Nebraska

Associate Director (2019, 2020)
Emerging Professionals Committee Chair / Co-Chair (2019, 2020, 2021)
Firm Roundtable EP Representative from DLR Group
Emerging Professionals Committee member (2017-Present)
AIA NE State Conference Committee (2019)

Initiatives: Testifying on behalf of AIA, Emerging Professionals Committee, Planning the First EP Sketch Competition,
Leading the EP ARE Testing Resources List Initiative and "Starting Point" guide,
Representing AIA/ AIAs at the Student Open House Event, Volunteering/ Organizing University of Nebraska College of Architecture for portfolio reviews and career fair prep sessions

AIA Central States Region Emerging Professionals Committee

Associate Representative from Nebraska (2020)
Committee Co-Chair (2021)
Committee Chair (2022)

Initiatives: Continuing the Emerging Professionals Friendly Firm Award Program Leading the 2021 AIA CSR Student Design Competition

Community Involvement & Volunteering

Volunteer for Habitat for Humanity
Participated in the clean-up of Everett Elementary for Green Apple Day of Service
Member and Assistant Organizer for Nebraska Women in Green
Organizer for the Lincoln Southeast High School 2019 10-year class reunion
Teaching assistant for class designing pro-bono projects for the Lincoln Food Forrest, Lincoln Bike Kitchen, and the Lincoln Re-Store
Design of the branding/logo for two Lincoln businesses – Porkccentric and Leisure Limousine
Volunteered in the restoration of one of the homes that inspired a Willa Cather novel
Volunteer at the Center for People
Leadership Lincoln Fellows Cohort 39

Current Associates Committee President
Sponsored to Attend Women's Leadership Summit 2019 & 2023
Equity Champion
Sustainability Champion
Lincoln AFTER Dark Planner
Lincoln Winterfest Planner
Regional Volleyball Tournament Planner

Key Projects

Gretna Elementary School #6 (Falling Waters)
Gretna High School Stadium Expansion
Gretna Elementary School #7* (Harvest Hills)
Elkhorn High School #3 (Elkhorn North High)
Gretna High School #2
14th and P street – Lincoln (Lululemon)
Lutz Lincoln Tenant Improvement Oscar 2.0 SD
The Scarlet Hotel at Nebraska Innovation Campus
Skutt Performing Arts Center Addition





Gretna East High School

Gretna East High
School
Gretna, NE

In 2020 the City of Gretna passed a bond issue that included \$139.5 million for a 2nd high school for the community. Initially the school will house 1,000 students and will have a max capacity of over 1,600. The school board selected another mythical creature (the other high school's mascot is the Dragons) the Griffins as the mascot for the new high school. The XGD Studio at DLR Group worked with the school board and other administrators to design the new brand which will define a new generation of students in Gretna.

The deliverable for this effort is both a brand guide that the school can use as their direction when implementing the brand and an experiential graphics package that implements the brand in high volume spaces within the facility. The brand guide includes direction on typography, color, identity mark usage. The guide also includes a series of badges that can be implemented if so desired and also demonstrates how business materials, uniforms and merchandise can be designed using the new Griffin brand. DLR Group provided brand development and experiential graphic design services. Emily served as the architectural team member who lead the design coordination of the auditorium and some of the outbuildings and fields.

Engaging Students in the Design Process: Father Flanagan's Boys Town Education Center

Boys Town, Neb.

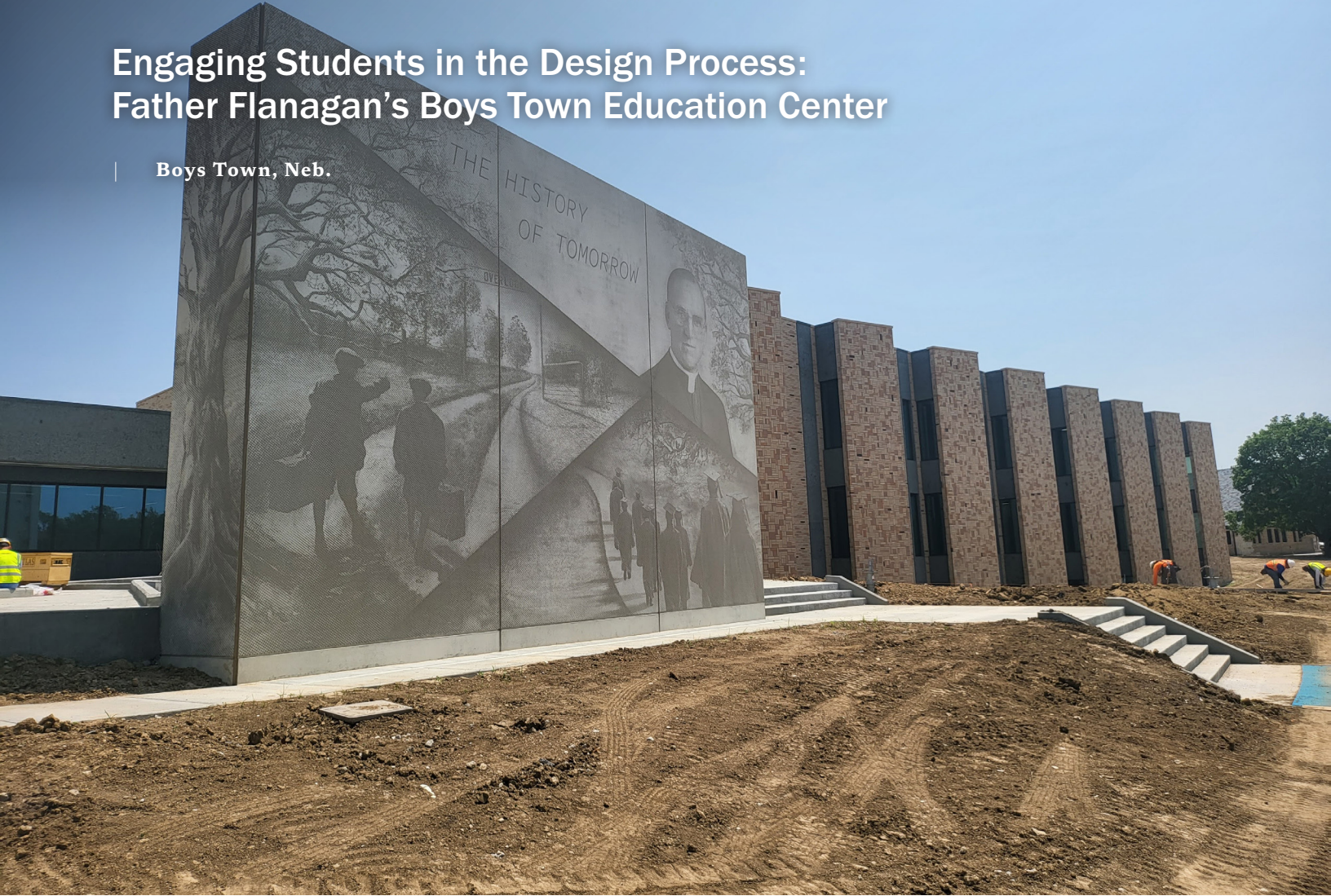

DLR Group is currently collaborating with stakeholders and staff members of Father Flanagan's Boys Home (Boys Town) on the design and construction of the new Boys Town Education Center.

The group determined that they would like to design and create a monument of Father Flanagan an important figure for Boys Town. Emily served as the architectural discipline lead on this project.

Gretna Stadium Expansion

| Gretna, Neb.

This project includes expansion and additions to the existing stadium and surrounding facilities. Work includes site work, expansion of the cast-in-place concrete stadium seating along with separate metal grandstands. Gretna features multiple buildings including toilets, press boxes, concessions, and team rooms.

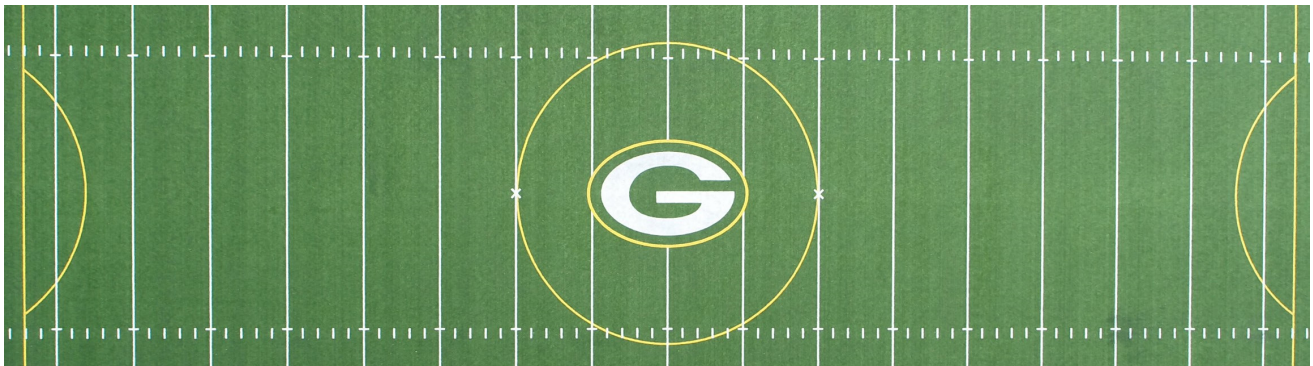
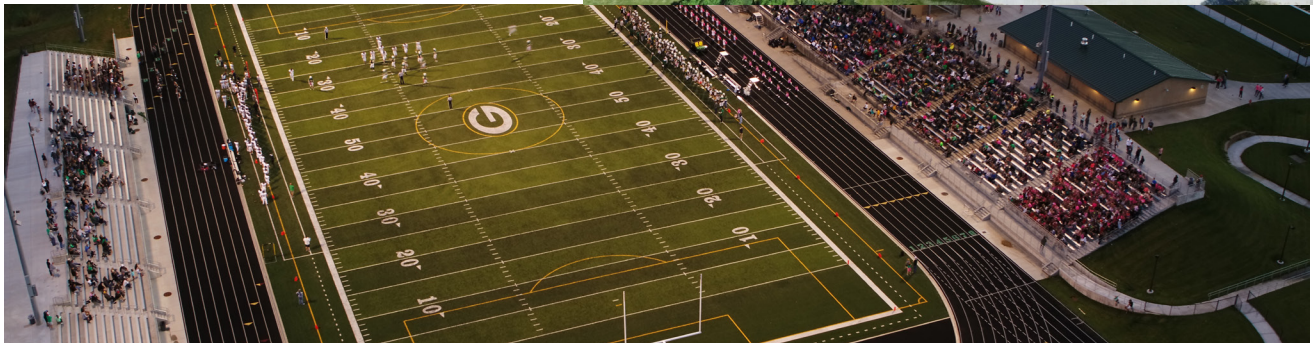



The Scarlet Hotel

Omaha, Neb.

Nebraska's capitol city of Lincoln is rooted in mid-western hospitality, which represents the city, state, and home of the University of Nebraska. Emily contributed her architectural expertise as a team member on DLR Group's design of the newest Tribute boutique hotel by Marriott - branded "The Scarlet Hotel" in celebration of the school's color - aims to capture the essence of spending a night in this great state. This essence is the character of the people who create Nebraska's renowned hometown personality. The upscale luxury hotel is in the heart of Cornhusker country and just a stone's throw from the University of Nebraska's Memorial Stadium. Nostalgic camaraderie and the thrill of game day find a new home in a diversity of food and beverage venues and lively social spaces. Each guest room features a dedicated story and personal item to showcase the individuals and the culture of this unique destination. This people-centric concept weaves its way into the architecture and the design of the facades. Large windows frame each guestroom, evoking an album of the extraordinary people inside and the individuality they represent. Perched on top of the brick masonry guest tower is an expansive roof deck lounge. From here, the view out over the plains gives guests a spectacular panorama of the Nebraska sunset as the day closes. Handmade materials and attention to detail enhance the building's base, where open, inviting social spaces welcome people to the Nebraska Innovation Campus' newest addition.

The six-story, 117,210 SF hotel houses 154 rooms, food and beverage options, small meeting spaces to complement an adjacent convention center, and unique programming born from a partnership with the University of Nebraska's Hospitality, Tourism, and Restaurant Management program. On the edge of the Nebraska Innovation Campus, hands-on learning happens in roughly 2,500 SF of educational space embedded in the hotel, including a test kitchen and dedicated delivery area. Generally, the guest experience is protected by a separation from back-of-house learning spaces, but the two come together in a centralized flex space. During high-volume events such as game weekends, this space hosts alumni and community gatherings. At quieter times, it flexes to a classroom environment. Ties to the Lincoln community were also deepened by use of local materials, and the inclusion of a locally known coffee shop and farm-to-table food program. DLR Group provided architecture services.

Gretna Elementary School 8

| Gretna, Neb.

As Gretna's 8th Elementary School, the building offers programs for preschool through 5th grade. Each elementary school within Gretna Public Schools has a unique, contextual, identity while also providing consistent organized areas within the building.

Emily lead the architectural team on this project .

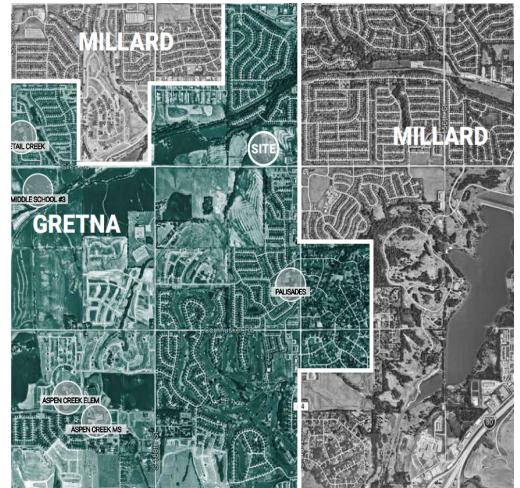
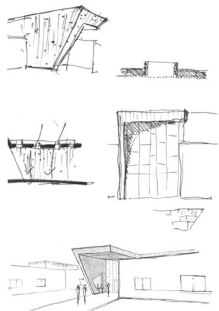
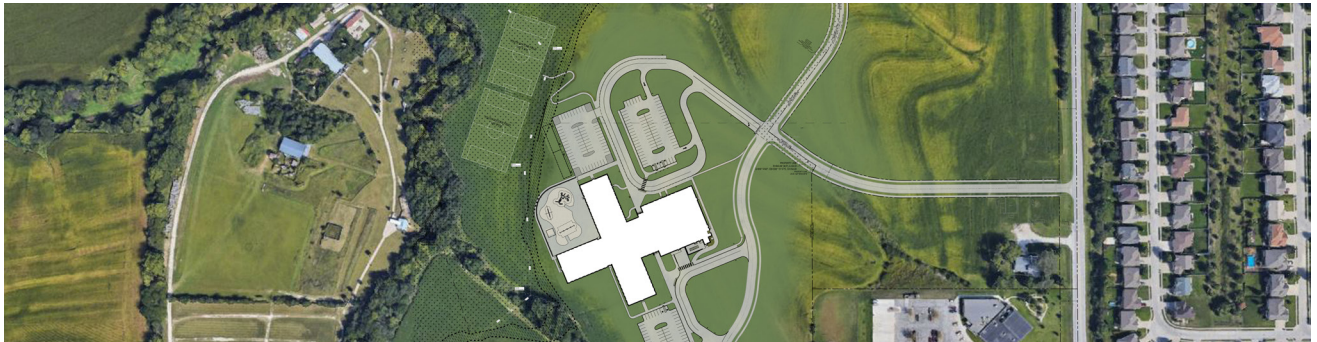

Lutz Lincoln Tenant Improvement Oscar 2.0 SD DD & CD

Lincoln, Neb.

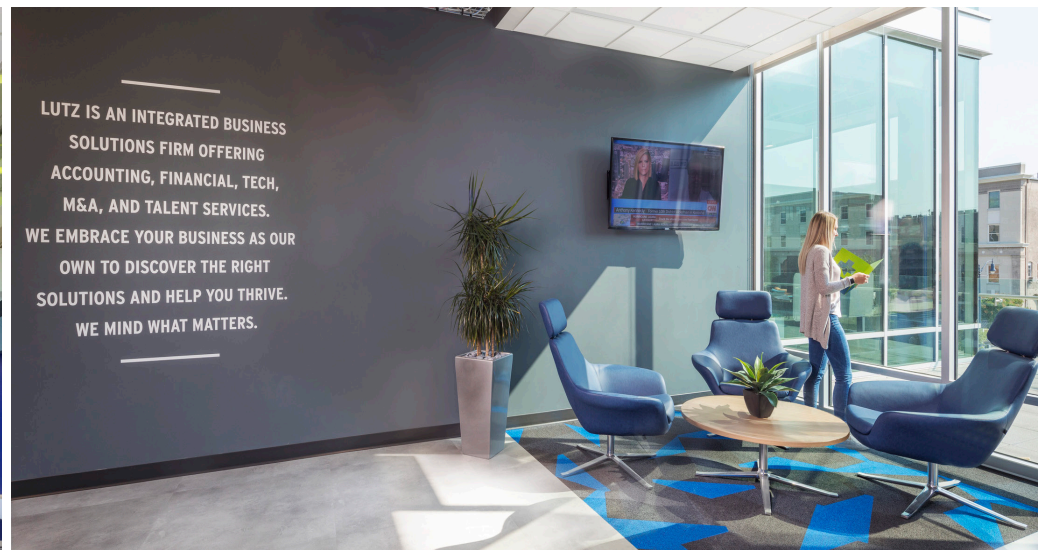

DLR Group has collaborated with Lutz & Company to create a modern, comfortable workplace.

Skutt Catholic HS Performing Arts Center

| Omaha, Neb.

This Project is a new performing arts center addition to the existing Skutt Catholic High School. The new performing arts addition includes a makeup room, restrooms, a scene shop, and mechanical / electrical storage.

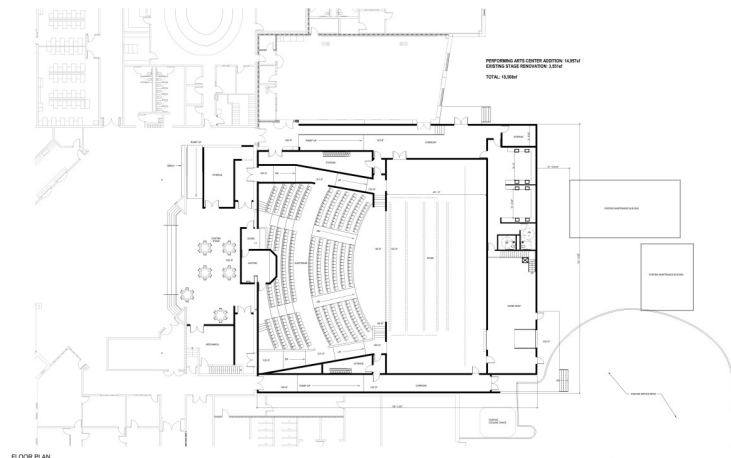
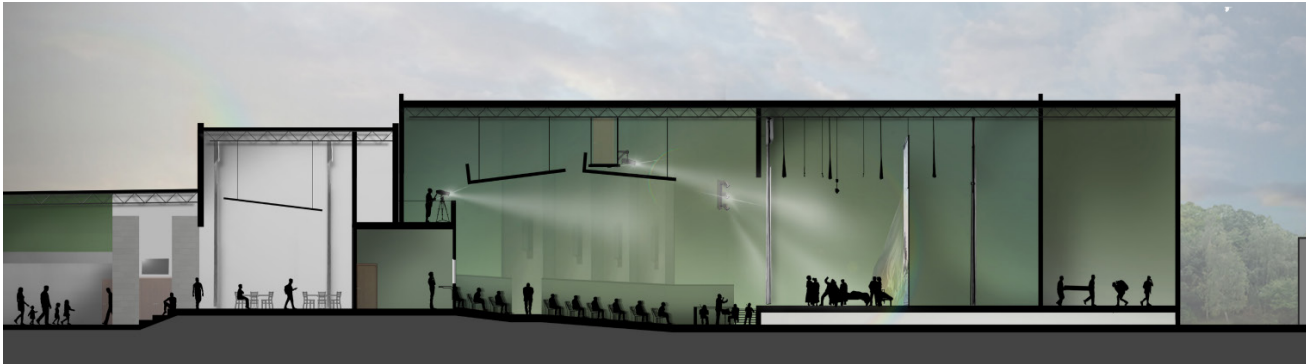

FLOOR PLAN
Skutt Catholic High School Performing Arts Center | Floor Plan

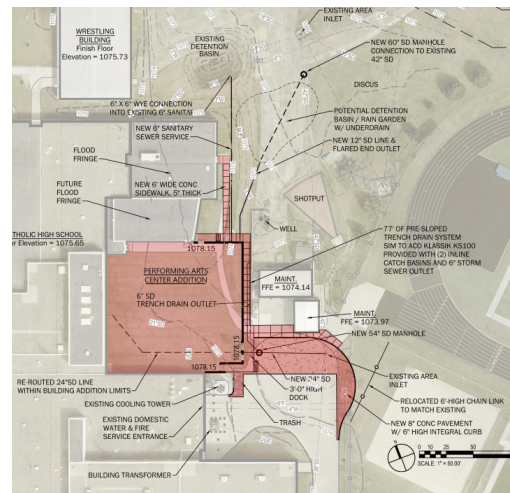

N' STUDIO

09 PODCAST 09

EP. 9

THE MV(E)P



WITH

EMILY ROESLER



AIAS - UNL Chapter

October 7, 2020 · Stockholm, Sweden · 🌐



🔔 EPISODE 9 OUT NOW 🔔

This week Geneva and Quinn sat down with Emily Roesler to talk about her experiences in the design field as an emerging professional and the many hats she wears. Emily is an associate designer at DLR Group, an AIA Lincoln Associate Director, AIA Nebraska Associate Director and Emerging Professionals Committee Chair, and AIA Central States Associate Representative for Nebraska. Through all her roles within the architecture community, her goal has remained the same, giving back to communities through architecture. She has been one of AIAS Nebraska's biggest supporters and we can't thank her enough for her commitment. [See less](#)

— at [Spotify](#).

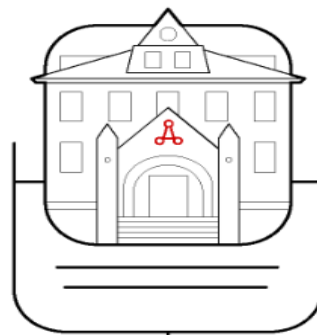

ESTD

2020

N' STUDIO

Emily Roesler has been featured on the University of Nebraska Lincoln's podcast titled, N'Studio Podcast. She shared her expertise and experiences in her almost hour long episode.



construction | the **people** you build with

14558 Portal Cir.
La Vista, NE 68138
Phone: (402) 339-2221

Date: 7/23/2023

Re: Emily Roesler
Letter of Recommendation

To whom it may concern:

This is a formal Letter of Recommendation for Emily Roesler, a Designer/Associate with DLR Group.

I have worked with Emily for the past two years on the Boys Town Education Center project located in Boys Town, Nebraska. This project is a new three-story 120,000 sqft Education Center for grades 4-12. From a construction assembly and systems standpoint, it is one of the most complex projects I have been involved with in the past 20 years.

It was clear early on that Emily was perfectly suited for her role in the project. She coordinated and kept all design disciplines accountable for their deliverables and quality of work. She is meticulous in her approach to her job and puts forth tremendous effort to make sure no details are overlooked.

Equally important to her capabilities, her affable character and team mentality makes her a joy to work with. Challenges and difficult conversations are handled with professionalism and the focus is always on facts the best outcome for the owner.

I hope we have the opportunity to collaborate on another project again soon.

Respectfully,

Tyler Adams

Tyler Adams
Project Executive
MCL Construction



DLR Group inc.

a Nebraska corporation

1128 Lincoln Mall, Suite 103
Lincoln, NE 68508

July 21, 2023

AIA Nebraska
355 N. 8th Street, Suite A
Lincoln, NE 68508

Re: 2023 AIA Nebraska Associates Award Nomination

Dear 2023 AIA Nebraska Associates Award Jury Chairperson and Jury Members,

It is my honor as a member of AIA Nebraska Board of Directors and an Architect at DLR Group, to recommend Emily Roesler, Assoc. AIA, for the 2023 AIA Nebraska Associates Award.

I have been working closely with Emily for over six years and have been fortunate to witness first-hand the leadership she exhibits both in the firm and in the community.

Serving in the Project Architect role, Emily embodies integrated design by meeting her client's goals and working seamlessly with all other disciplines. She displays leadership by finding new and creative means to accomplish the vision and goals on all projects that she is involved in. She goes above and beyond, leaving a lasting impact by collaborating with the design and construction team on prominent projects. She has been described as an "ideal project partner" by a Contractor's Project Executive on one of her recent projects. In the office – she supports a fun office culture and actively leads in-office events, student workshops, and industry-related engagements.

In addition to her contributions to the profession, Emily is incredibly involved in the architectural community. She is the current AIA Lincoln President and has been on their Board since 2018, leading the Big B.A.D. Birdhouse Project since 2021. She was AIA Central States Region Emerging Professionals Committee Chair/Co-Chair from 2019-2021 and has continued to be an advocate for emerging professionals as part of AIA Nebraska Emerging Professional Committee. She led the 2021 AIA CSR Student Design Competition and was a contributing member helping with the Emerging Professionals Friendly Firm Award Program initiative.

Emily is a true asset to our profession and our community and her diligent efforts make her an ideal candidate for this award.

Sincerely,

A handwritten signature in black ink that reads "Heather Hughes".

Heather Hughes, AIA, LEED AP
Architect | Principal
DLR Group